

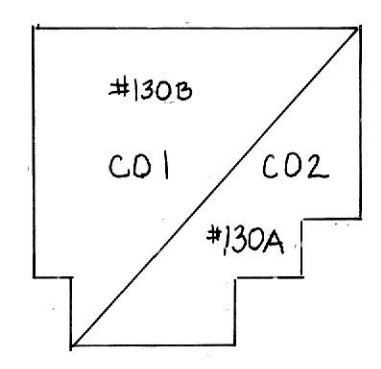

INSERT "A" BLOCK 408 LOT 26  
SCALE: 1" = 20'



SHEET 87

NEW JERSEY DEPARTMENT OF THE TREASURY  
DIVISION OF TAXATION  
LEGAL PROPERTY AND PUBLIC UTILITY BRANCH  
APPROVED AS A TAX MAP PURSUANT TO THE  
PROVISIONS OF CHAPTER 175, LAWS OF 1975, ETC.  
FOR THE DIRECTOR, DIVISION OF TAXATION  
*J. N. DiStasio*  
BY: *J. N. DiStasio* P.E. & L.S. CHIEF  
DATE: JUL 31 1978 # 500P SERIAL NO. 577

REVISIONS	
1	2-1-1978
2	8-14-1981
3	B 405 L 2.01 3.01 3/15/94
4	1/22/16 B 408 L 1.01, 1.02, 1.03
5	2/23/2016 B 408 L 2.6
6	3/7/2019 B 408 L 2.6
7	2/8/2023 B 404 L 15.01 & 15.02
8	B 405 L 2.1
9	

TAX MAP  
TOWNSHIP OF CRANFORD  
UNION COUNTY, NEW JERSEY  
SCALE 1" = 50'  
JUNE 1977

PREPARED BY:  
**AERO SERVICE**  
EDMUND P. DUPUY  
N.J. LICENSED LAND SURVEYOR  
812 CHURCHVILLE ROAD  
SOUTHAMPTON, PA 18966  
GREGORY A. SGROI  
TOWNSHIP ENGINEER

SHEET 85