

House

Door

5/4 x 6 composite decking

20.5 x 25 =
(9.25 x 9.42)

covered

Scale 1/4" = 1'

Marc Blumberg
19 Blake Ave
Cranford NJ 07016
(908) 577-4037

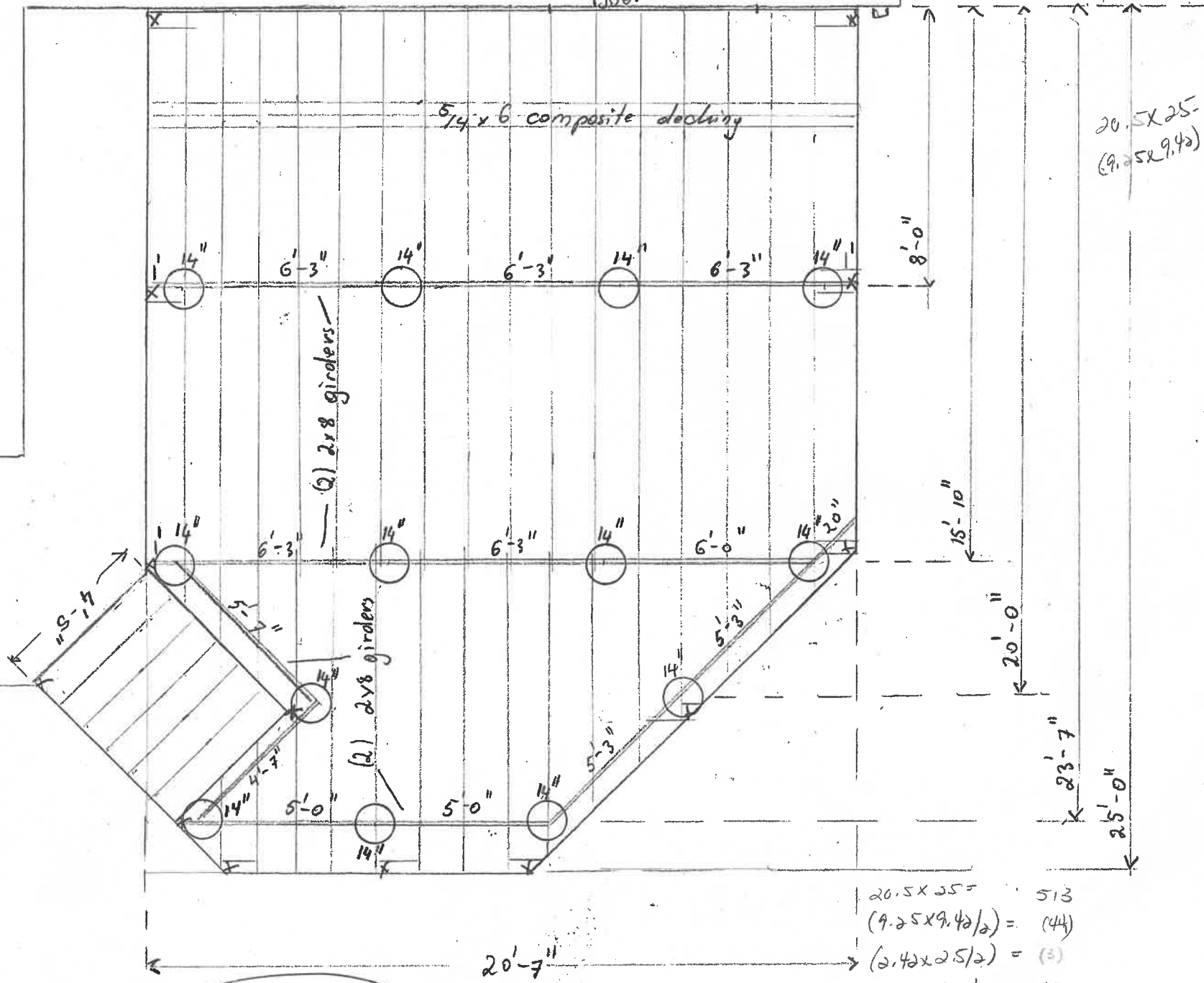

| | |
|---------------------|-----------|
| 20.5 x 25 = | 513 |
| (9.25 x 9.42) / 2 = | (44) |
| (2.42 x 2.5) / 2 = | (3) |
| 4.5 x 4.5 / 2 = | 10 |
| | <hr/> 476 |



0.24" Ø 5" STRUCTURAL LEDGER LOCKS
5"-6" O.C. AND 2 ON EACH END 11' APART

GALVANIZED OR COPPER
COUNTER FLASHING

ICE AND
WATER BARRIER

LEDGER IS TO BE CONNECTED
WITH 5/2 LEDGER LOCKS
TO THE HOUSE PLATE
OR TO FOUNDATION WITH
MASONRY ANCHORS
(GALVANIZED).

ALL LUMBER IS TO BE
PRESSURE TREATED.
ALL 6x6 POSTS MUST BE
GROUND CONTACT.

ALL OTHER HARDWARE
LIKE TCO NAILS, HANGERS,
3" FRAME NAILS MUST BE
GALVANIZED AND DECKING
SCREWS ARE STAINLESS
STEEL.

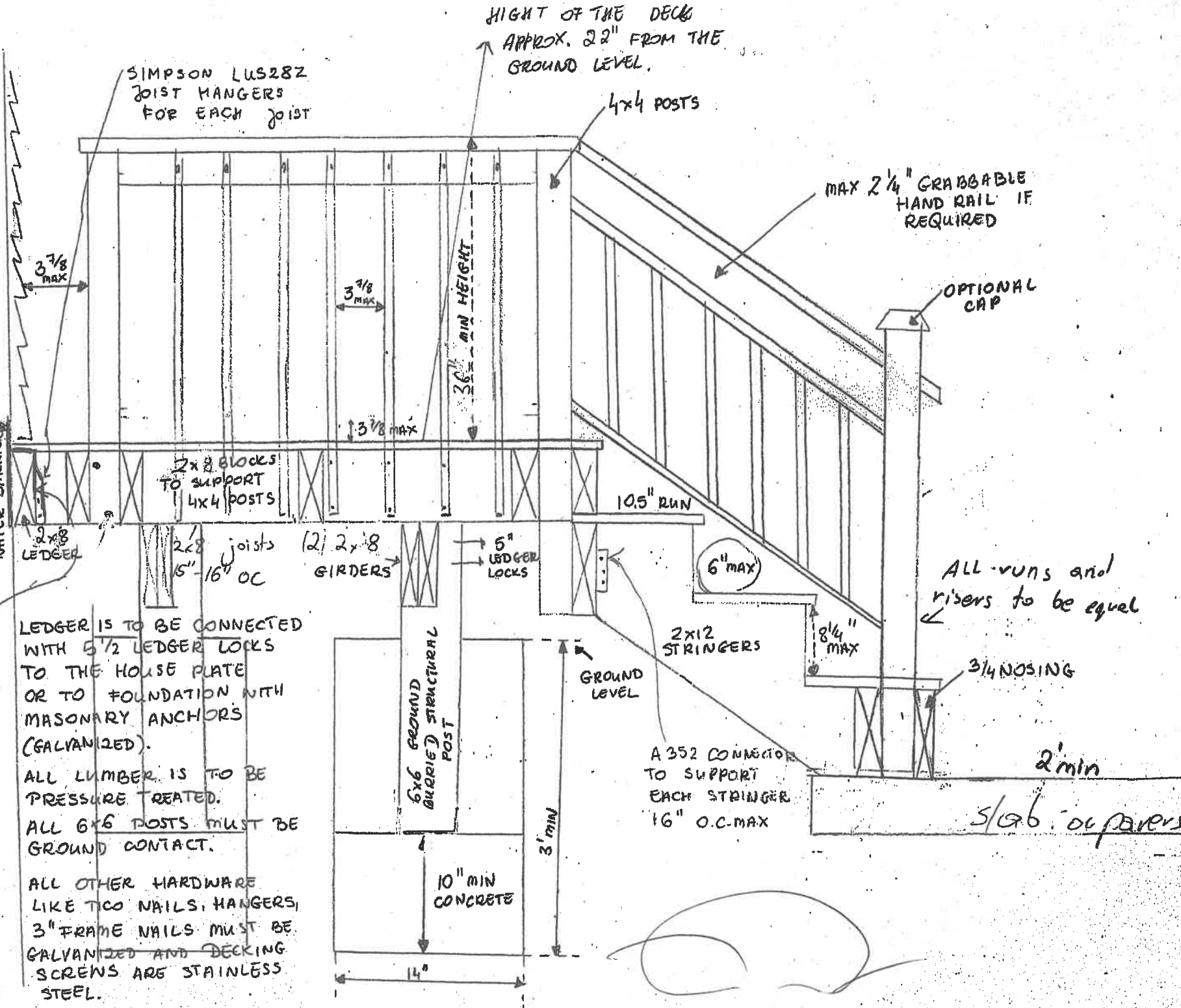

HIGHT OF THE DECK
APPROX. 22" FROM THE
GROUND LEVEL.

4x4 POSTS

MAX 2 1/4" GRABBABLE
HAND RAIL IF
REQUIRED

OPTIONAL
CAP

2x8 BLOCKS
TO SUPPORT
4x4 POSTS

10.5" RUN

2x8 Joists
15"-16" OC

(2) 2x8
GIRDERS

5"
LEDGER
LOCKS

6" MAX

ALL runs and
risers to be equal

2x12
STRINGERS

8 1/4"
MAX

3/4 NOSING

GROUND
LEVEL

A352 CONNECTOR
TO SUPPORT
EACH STRINGER
16" O.C. MAX

2" min

Slab on piers

10" MIN
CONCRETE

3' min

14"